

iRUNE

User Manual

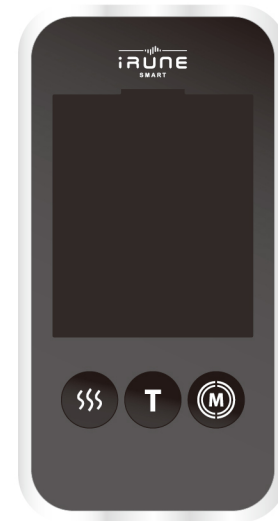

Read this manual before using the product
for safety and use the product properly.



MEDIRUNE Co., Ltd.

Medirune Co., Ltd.
www.medirune.com
2-108, Taejunggongdan-gil 42-10,
Wonju-si, Gangwon-do, Korea 26311
Tel. +82-33-765-5739 Fax. +82-33-765-5793

[EC REP] European representative
Vario Tech GmbH
Ludwig Erhard Str. 30-34 65760
Eschborn / Germany
Tel +49 - 6196 - 7755 945

Preparation

Product features, Specification ——— 03p

How to use

Quick guide ——— 04p

Names and functions of each part ——— 06p

Pad and Electrode ——— 08p

Battery charge ——— 09p

How to use ——— 10p

Others

How to handle and keep ——— 14p

Troubles ——— 16p

Limited warranty ——— 17p

Read this part before using the product.

- Dangers, warnings, cautions and information specified in this manual are to encourage you to use the product properly and to prevent damages to people or property due to inappropriate use.
- You should follow the points below specified in this manual.
- Medirune expressly disclaims all damage resulting from breakdown or injury due to random disassembly or careless handling.
- Keep this manual at hand for reference.
- The following are the points and their meanings specified in manual.

Components

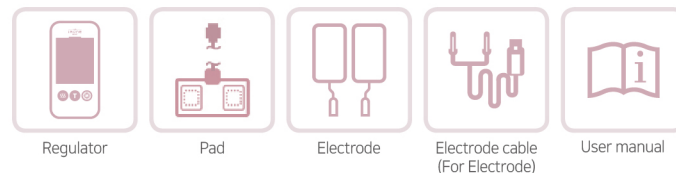

Product	Personal combination stimulator
Model name	I-200L(advanced type)
Purpose of use or effect	It is electronic functional medical Product that helps muscle pain relief and Menstrual pain also
Power supply	DC 3.7V/1100mAh(Li ion rechargeable battery)
Battery life span	Max 20 hour with TENS used Max 2 hour with Thermal + TENS used
Battery charging time	Approx. 3 hour (It depends on the conditions.)
Operating hour	20 min (default)
Thermal Temp	High : 40℃±1℃ / Low : 37℃±1℃
Regulator size	52.2×99.5×16mm
Regulator weight	73.4g (Battery included)
Operating environment	Temp:-20℃ ~ 40℃, Humidity:30% ~ 85%, Pressure:70 ~ 106KPa
Transport & store environment	Temp:-20℃ ~ 60℃, Humidity: below 95%, Pressure:70 ~ 106KPa
Classification	Class II b / BF type
Standard	EN60601-1 : electric mechanical safety test EN60601-1-2 : EMC test

QUICK GUIDE

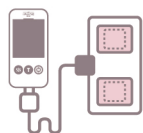

1. Connect the pad with the regulator.

Plug the pad cable to the bottom.

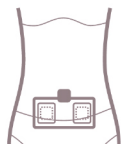

2. Attach the pad to the pain area.

Remove the opaque film from the pad gel.
Attach it to the Pad (black surface) and then apply the pad on the skin.

※ Use the transparent film () it helps to protect the pad gel.



3. Turn on the power.

1) Check if the power switch is off at the bottom of the regulator.



4. Select the mode.

1) T.E.N.S Mode



Mode A

Mode B

Mode C

2) Heat Mode : Thermal therapy - Select H(High) or L(Low)

※ T.E.N.S Mode and Heat Mode can be worked in the same time.

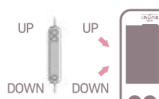

5. Adjust the intensity.

Use the Up/Down buttons on the top left of the regulator.

QUICK GUIDE

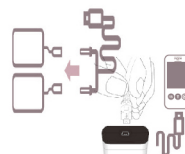

1. Connect the electrode with the regulator.

Plug the electrode cable to the bottom.



2. Attach the electrode to the pain area.

Remove the protection film from the electrode.
Attach the electrode on the skin a pair.

※ Keep the film to protect the electrode.



3. Turn on the power.

1) Check if the power switch is off at the bottom of the regulator.

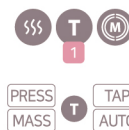

4. Select the mode.

Massage Mode

Mode : PRESS, TAP, MASS, AUTO

※ AUTO is rotated 1min (PRESS→TAP→MASS)

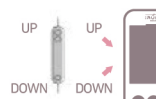

5. Adjust the intensity.

Use the Up/Down buttons on the top left of the regulator.

NAMES AND FUNCTIONS OF EACH PART

1. Switches, connectors and indicators

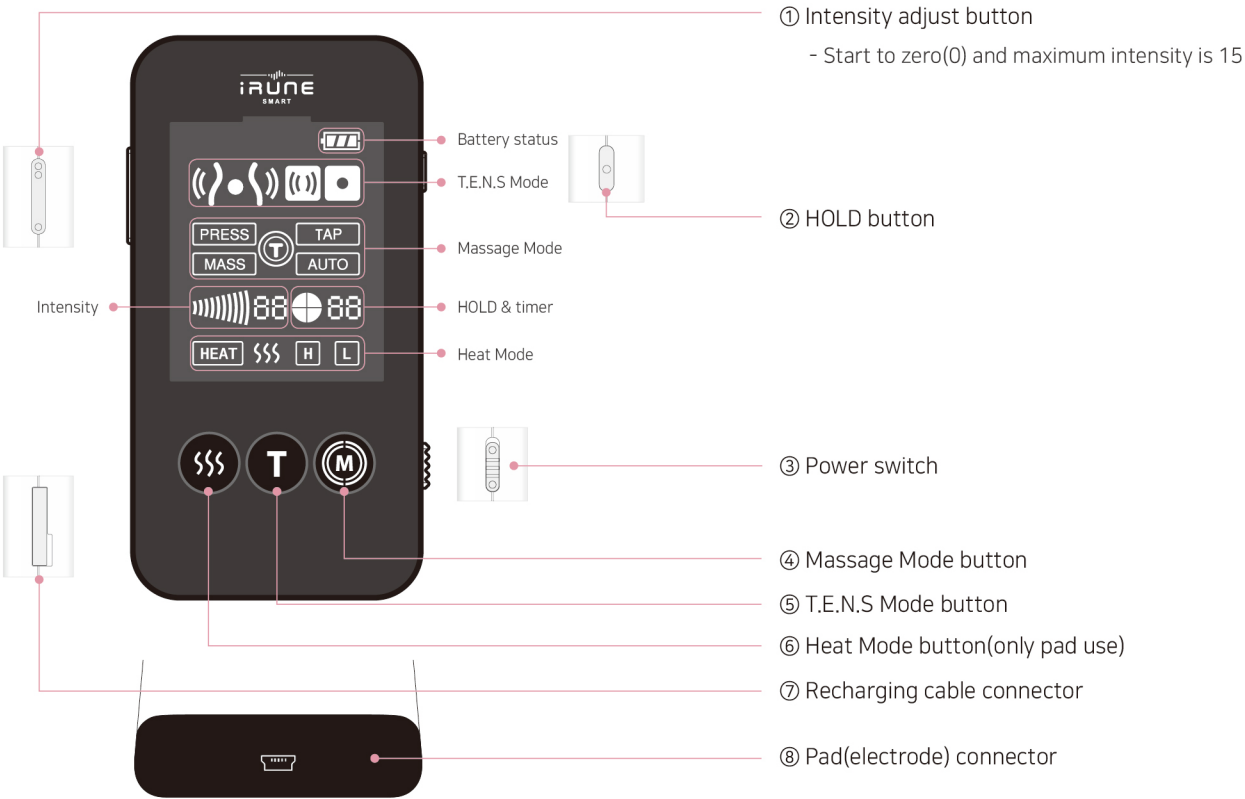

PAD AND ELECTRODE

2. Indicators and features for pad and electrode

■ Pad : used for T.E.N.S Mode and Heat Mode

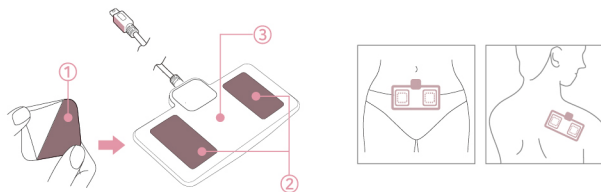

- ① Gel : Removed the opaque film from the gel
- ② Electrode part : Attached to the affected area
- ③ Thermal area

■ Electrode : used for T.E.N.S Mode and Massage Mode

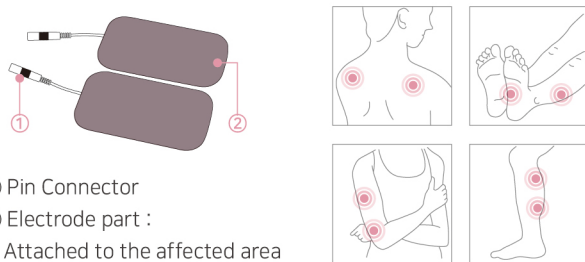

- ① Pin Connector
- ② Electrode part : Attached to the affected area

BATTERY RECHARGE

1. How to Recharge

- 1) When the battery power remains by less than 10%, the battery icon blinks and the buzzer makes 'beep' sounds three time.
- 2) Connect recharging cable into the recharging cable connector of regulator. (Recharging indicator : red lamp recharging, green lamp full)

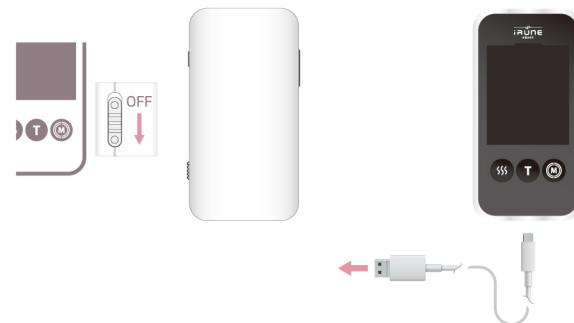

! INFORMATION

- Before use, must recharged the battery fully.
- The warranty of battery is 6 months from the date of purchase.
- USB recharging cable can be connected USB port or PC or adaptor.

! CAUTION

- While recharging, the regulator cannot work.

1. Starting

- Slide up the switch on the regulator to turn on the power.
- When the power is turned on, the buzzer goes off once and every icon is shown on the LCD for 2 sec, then the stand-by state begins with the LCD showing only the battery icon.

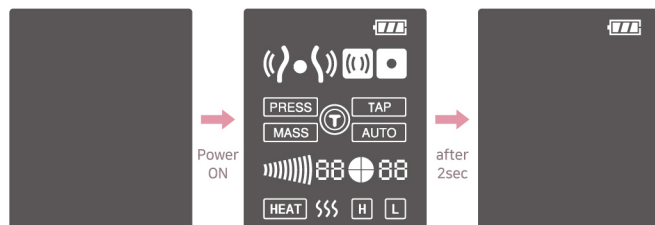

- After the stand-by state, you can select the mode.

! INFORMATION

- If there is no operation over 30 sec after power is regulator turned off. Slide the Power switch and then turn it on.

! DANGER

The following medical equipments cannot be used together with this product. Otherwise, such equipments will malfunction. Consult a specialist first

- Implantable electronic medical equipment like pace maker
- Life support electronic medical equipment like ventilator
- Pluggable electronic medical equipment like ECG recorder
- Do not use the heat unit along with RF surgical unit, cardiac catheter and surgical medical equipment.

2. Mode selection and operation

1) T.E.N.S Mode

- There are 3 modes. (A, B, C) To select mode click TENS Mode button.



- On selecting a mode, it takes 2 sec to start the mode operation. The indicator on the LCD shows the selected mode icon blinking every 0.5sec.
- Always intensity starts to Zero. You can adjust intensity, Which is indicated as below.



- Operating time is set in 20 min. The remaining time is shown on the LCD.



- While in operation, if the Hold button is pressed for 1sec, the HOLD Mode starts.



- To unlock HOLD Mode, press HOLD button for 2 sec. if there is no operation over 30 sec, it is change HOLD Mode.



! CAUTION

- Do not use the product around the heart, the neck, the abdomen, the head, the pubic region, the parts injured or infected or skin trouble and in the mouth.
- Turn it off the regulator, when the connected cable is disconnected.
- If the cable is broken, call our customer center.
- Do not disassemble, repair or alter the product randomly.

2) Heat Mode(for pad)

- ① There are consisted 2 modes. Press the switch once for High mode.
Press it twice for Low mode.
Press it three times for waiting mode after turn off Heat Mode



- ② When selecting a mode, in 2 sec operation starts. The LCD shows the selected mode icon blinking every 0.5 sec to indicate it is working.



- ③ The operating time is set in 20 min. The remaining time is shown on the LCD. (Refer TENS Mode.)
- ④ While in operation, if the Hold button is pressed for 1 sec, the HOLD Mode starts. (Refer TENS Mode.)
- ⑤ To unlock HOLD Mode, press HOLD button for 2 sec. If there is no operation over 30 sec, it is change HOLD Mode. (Refer TENS Mode.)

! INFORMATION

- The Heat Mode can be used only when the pad is connected.
- In TENS Mode, Heat Mode can be added.
- When the battery power remained less than 10% the Heat Mode can not be work.
- In Heat Mode, if any abnormality (disconnect cable etc.) arises, the buzzer goes off five times and the LCD indicates the stand-by state.
- If the pad or pad cable is broken, call our customer center.

3) Massage Mode

- ① There are 4 modes. Click the switch once for PRESS, twice for TAP, three times for MASS, and four times for AUTO mode.

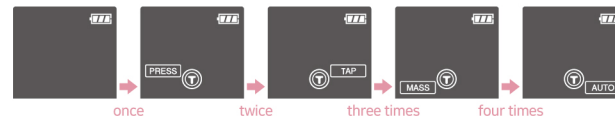

- ② Once a mode is selected, it operates in 2 sec. The LCD shows the selected mode icon blinking every 0.5 sec, meaning it is working.
- ③ Always intensity starts to Zero. You can adjust intensity. (Refer TENS Mode.)
- ④ The operating time is set in 20 min. The remaining time is shown on the LCD. (Refer TENS Mode.)
- ⑤ While in operation, if the Hold button is pressed for 1 sec, the HOLD Mode starts. (Refer TENS Mode.)
- ⑥ To unlock HOLD Mode, press HOLD button for 2 sec. If there is no operation over 30 sec, it is change HOLD Mode. (Refer TENS Mode.)

! CAUTION

- Sensitive users may get a shock depending on intensity, so be careful with the intensity control.

! WARNING

- You must consult a specialist first if you have one of the following symptoms. Medirune expressly disclaims any damage resulting from using the product without consulting a doctor.
- Sensitive users may get a shock depending on intensity, so be careful with the intensity control.
 - 1) Acute diseases, tumors, cardiac dysfunction, thrombus, high fever, abnormal blood pressure, diabetes
 - 2) Skin sensory loss, dermatosis
 - 3) Abnormal nerve sensations and blood circulation
 - 4) Other diseases and complications
 - The disabled, infants, pregnant women and mentally ill people must not use the product.
 - Those who have difficulties controlling body and sensing heat and subjective symptoms, drinkers and sleeping-pill takers must not use the product.

1. How to clean the gel and electrode

- 1) Turn off the power.

Separate the pad or electrode from the connection cable.

- 2) Use your fingers to gently clean the electrode in small amount of running water for seconds. (Be careful to keep the connection cord of the pad and the connector of the electrode away from water.)
- 3) Try a natural dry.
- 4) Keep the gel or electrode to the holder.

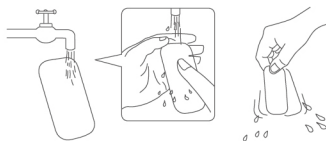

! INFORMATION

- Keep the pad or electrode always clean. Be careful not to leave your hand prints on the gel or electrode. It could deteriorate adhesive strength. (See how to handle and keep.)
- Do not yank the pad or electrode connection cables or do not bend the electrode forcefully and unnecessarily. It could cause a malfunction.
- The gel for pad or electrode is disposable.
- When the adhesive surface is damaged, replace new one.
- If a piece of paper tissue sticks to the adhesive surface, do not take it off forcefully but add a little water, then it will come off easily.

! WARNING

- Medirune expressly disclaims any damage caused by not observing the cautions and other particular guidance mentioned here.
- Do not continuously use the product for over specified time(20 min) on one spot. It may cause muscles to get tired, leading to abnormal conditions.
- Do not use it around shortwave or microwave treatment equipment (min. 1M).

2. How to maintain and checkup the product

- 1) To prevent accidents, use the parts the manufacturer recommends or sells.
- 2) Do not alter or disassemble the product, which will cause damage, malfunction, injury and accidents.
- 3) Do not soak the product in water. If it is soaked in water, wipe it out immediately with a dry fabric.
- 4) If 3) happens, inquire of a local selling agent or our home page.

3. How to dispose of the product

In accordance with the ordinances of each local municipality, dispose of the product appropriately.

! CAUTION

- Do not use hot water, detergents and chemicals(thinner, benzol etc).
- Do not cause scratches to the adhesive surface with fingernails or brushes.
- Do not keep it in a hot and humid place with direct sunlight.
- Do not wipe out the adhesive surface with tissue or fabric.
- When wash them with water, be careful not to get pad connector and electrode connector inside wet with water. It could cause a malfunction.
- When the product malfunctions or you feel something wrong with your body while using it, stop it immediately. Consult a doctor for body or skin trouble and follow the doctor's instruction.
- To attach a pad or electrode to other parts while using the product, be sure to convert the intensity control button to "00" position and then attach it. Otherwise, it could cause a strong electric shock.
- Do not start other treatment while using the product. It could affect the product's setting and timing.
- Do not use the product with infants or those who cannot express themselves properly. It could cause accidents or diseases.
- Avoid wet places like bathrooms when using the product. Do not use it while taking a bath or shower. It could cause a severe electric shock.
- Do not use the product while sleeping. It could cause malfunction or the pad or electrode unnecessarily move to other body parts.
- Do not use it while driving. If it is affected by some strong stimulation, it could cause accidents or problems.
- After using the product, do not leave the pad or electrode attached to the skin. Extended attachment could cause itches or troubles or infections on skin.

TROUBLES

Problem	Measures
Power is not on	<ul style="list-style-type: none"> · If the battery is discharged, charge it again for re-use.
Power is on, but no stimulus	<ul style="list-style-type: none"> · Check if the attached side of pad or electrode is detached from the skin, and then adhere the attached part to the skin. · Check if two electrodes are connected to a connection line for one. · Connection to the connection line is not made. · Check if the intensity adjustment is set for "00", and then adjust the intensity. · Check if the electrodes are overlapped for attachment.
Too weak stimulus	<ul style="list-style-type: none"> · The adhesion of the pad or electrode is detached. · The attached part is not adhered on the skin. · The intensity adjustment is weakened.
Power is off while in use	<ul style="list-style-type: none"> · The battery has been discharged. Use it after recharging. · The operating time of 20 minutes has been exhausted. Please use it again.
Less adhesive pad or electrode	<ul style="list-style-type: none"> · The transparent film of the attached side is not removed. · The attached side is dirty that it has to be washed before using it. · The attached side is damaged that it has to be replaced with new one.
No heating	<ul style="list-style-type: none"> · If the remaining battery is insufficient, recharge it. · The electrode is connected. Connect the pad. · The connector of the pad is not connected or it is short-circuited.
In the event of having possible skin problem during the use	<ul style="list-style-type: none"> · Do not use over 20 minutes of same pain area. · When the attached side is dirty or dried, the attached part is washed off with water. · When the attached side is damaged, replace it with new one since the electrode and gel are consumable goods. · If you have skin problem or skin disease, stop using the product and consult with physician.

LIMITED WARRANTY

1. You are entitled to a 1-year warranty service for defects under normal use according to the user manual and other caution phrases on the labels attached to the regulator.
The limited warranty period starts on the date of purchase.
2. If you need receive any repair service within the limited warranty period, visit our web site or call our service center.
3. The limited warranty is not applied to the items below.
 - 1) Troubles or damage resulting from user's mistake or inappropriate repair or replacement or alteration
 - 2) Troubles or damage due to intentional or accidental dropping of product after purchase
 - 3) Defective functioning or damage attributable to fire, earthquake, flood, lightning, thunderbolt, other natural disasters, pollution, surge, and abnormal power supply not specified (voltage, frequency etc)
 - 4) Conditions not provided in this manual
 - 5) When the date of purchase, customer's name, and seller's name are not written in this manual, or when such records are modified.
 - 6) Disposable.
 - 7) When the cause of defective functioning does not lie in this product.
 - 8) Defects or damage by using the product in a way not specified in this manual.
4. This manual is not reissued. Don't lose this manual. Keep it carefully.
5. This document includes limited warranty information under the terms and conditions and within the specified period.
This document of limited warranty does not restrain you of your legal rights.

Limited Warranty	
Customer	Place of purchase
Address	Address
Name	
TEL	Seller's name
Product name	Date of purchase(dd/mm/yy) / /
Model name	1-year warranty from the date of purchase

medirune co., Ltd.

